

INSTALLATION GUIDE

Puff Light

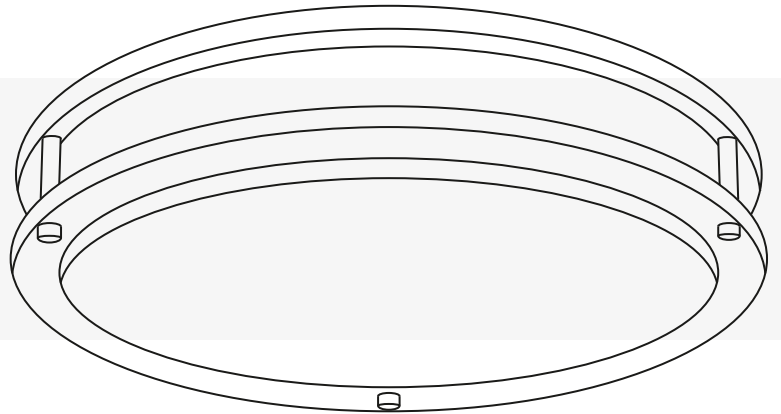

INSTALLATION DIAGRAM:

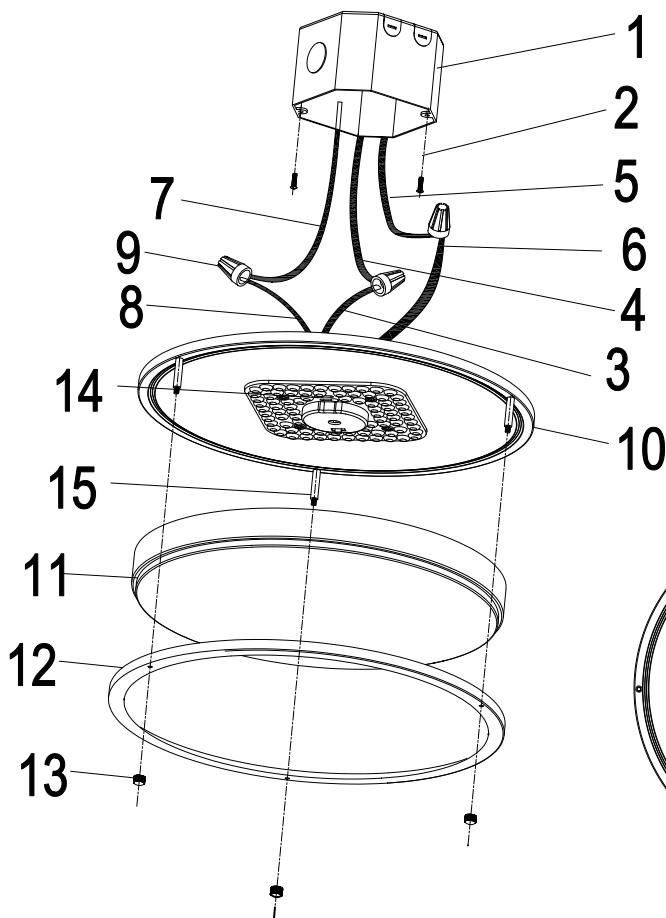

1. Outlet Box
2. Mounting Screw
3. Fixture Ground Wire
4. Supply Ground Wire
5. Black Supply Wire
6. Black Fixture Wire
7. White Supply Wire
8. White Fixture Wire
9. Wire Nut
10. Fixture Pan
11. Shade
12. Frame
13. Decorative Nut
14. Keyhole Slots
15. Decorative Bar

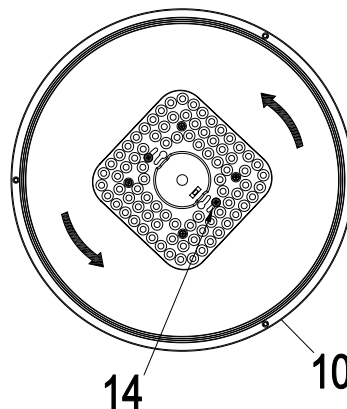

PRECAUTIONS:

1. Please install by professional people.
2. All installation, maintenance, and replacement work must be performed with the power turned off.
3. Before installation, please check the structure and material of the installation position of the light to confirm that it is firm and reliable enough to support the light. After installation, check whether the suspended equipment is installed firmly or not.
4. Prior to cleaning the light, make sure it has been disconnected from the power supply and clean it with a dry cloth. Do not use anything that contains chemical or corrosive materials to clean it.

*Pictures and diagrams in this IM are for illustrative purpose only.

INSTALLATION GUIDELINE

1. Remove the diffuser by turning 3 decorative nuts (#13) on metal ring anti-clockwise.

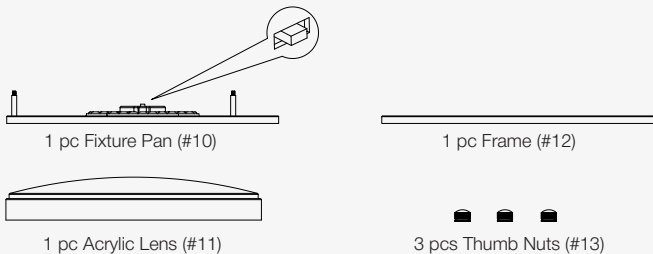

Remark:

If the one you chosen is color temperature switchable lamp please set up the CCT you want before installation with dial Switch.

Warm White(2700K)
Soft White(3000K)
Natural White(3500K)
Bright White(4000K)
Daylight(5000K)

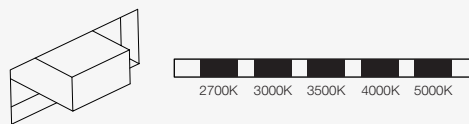

2. Thread the mounting screws (#2) onto the outlet box (#1), leaving about 1/2 inch unscrewed.

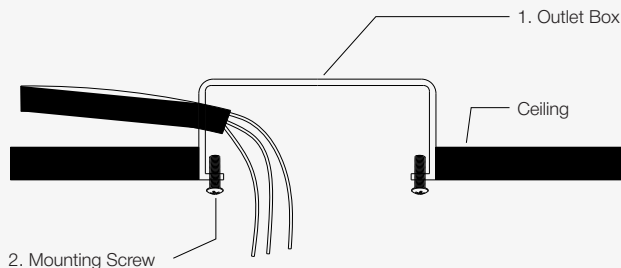

3. Connect wire by wire nuts (#9), then put the wires into the outlet box (#1).

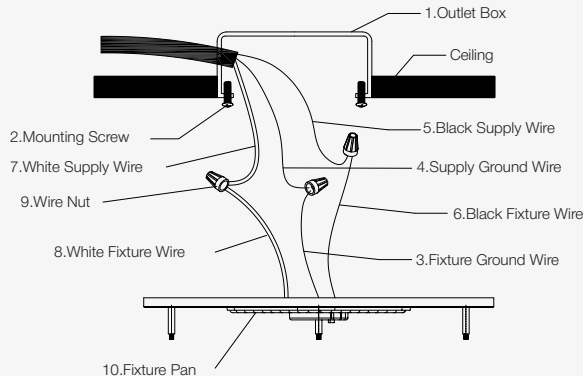

4. Place the Fixture Pan (#10) over the Outlet Box (#1) and onto the Mounting Screws (#2), making sure they feed through the Keyhole Slots (#14), rotate the Fixture Pan (#10) so that the Mounting Screws (#2) slide into the narrow ends of the Keyhole Slots (#14).

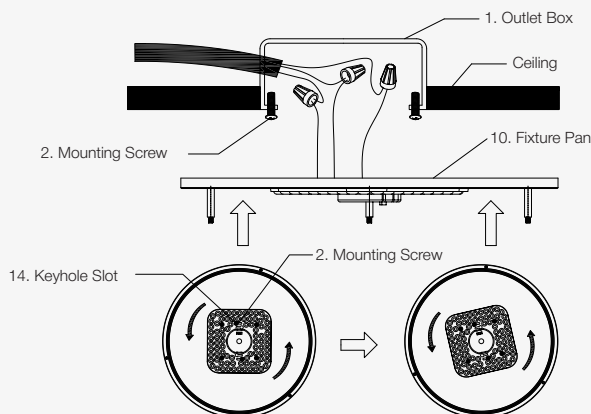

*Pictures and diagrams in this IM are for illustrative purpose only.

INSTALLATION GUIDELINE

5. Align the diffuser on the canopy, then place the metal ring on the diffuser. Let 3 decorative bars (#15) extend out from the metal ring. Twist 3 decorative nuts (#13) on top clockwise to tighten the ring and diffuser. Installation is complete. Turn on the power

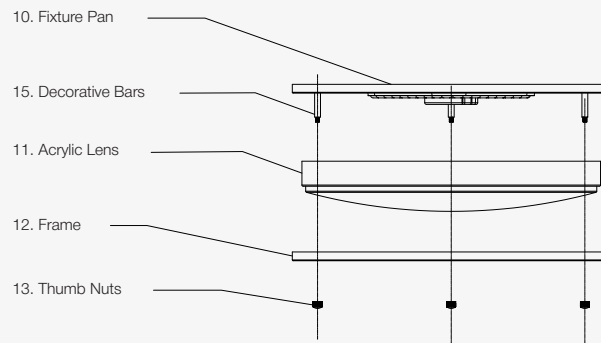

*Pictures and diagrams in this IM are for illustrative purpose only.