



Article No	:	
Version	:	08.25
Prepared By	:	
Checked By	:	

# EMERGENCY LIGHT EXIT SIGN



## ORDERING INFORMATION

Product Code	Operating Voltage	Discharge Time	Color Of The Sign
KL-7037R	120/277V	90 Minutes	Red
KL-7037G*	120/277V	90 Minutes	Green

\*Not In Stock

## FEATURES

- LED Technology
- High Visibility
- Multiple Mounting Options
- Battery Backup for power cut situations
- Photoluminescent Signs that glow in Dark
- Follow Compliance and Regulations- UL Listed

## SPECIFICATIONS

Operating Temperature	-10°C - +45°C
Product Wattage	1.2W
Input Voltage Range	120-277 VAC
Input Frequency	60Hz
Power Factor	1
Battery	1.2V NiCad - Maintenance Free
Charging Time	24 Hours
Discharge Time	90 Minutes
Mounting	Wall, Side & Ceiling
Finish	White
Frame Material	ABS
Ingress Protection	IP20
Impact Protection	03

An LED Exit Light is an indispensable safety feature designed for various types of buildings and facilities. Engineered to provide reliable illumination during emergencies or power outages, this fixture ensures the safe and efficient evacuation of occupants. Strategically positioned to delineate exit pathways, these lights offer clear directional guidance, facilitating swift and orderly evacuation in the event of fires, natural disasters, or other emergencies. By minimizing panic and confusion, our LED Exit Lights contribute significantly to overall building safety.



Warranty



Rated Life



(864) 401-8156

sales@krutled.com

111 Preamble Ct, Anderson, SC- 29621, United States.

All rights reserved. Krut LED reserves the right to make changes to specifications and/or discontinue any product at anytime without the notice. Information presented in this document is reliable and accurate, It does not represent any quotation or contact. No liability will be accepted by the contributor by the publisher for any consequences for its use. Reproduction in whole or part is prohibited without prior consent of the copyright owner.

## DIMENSION

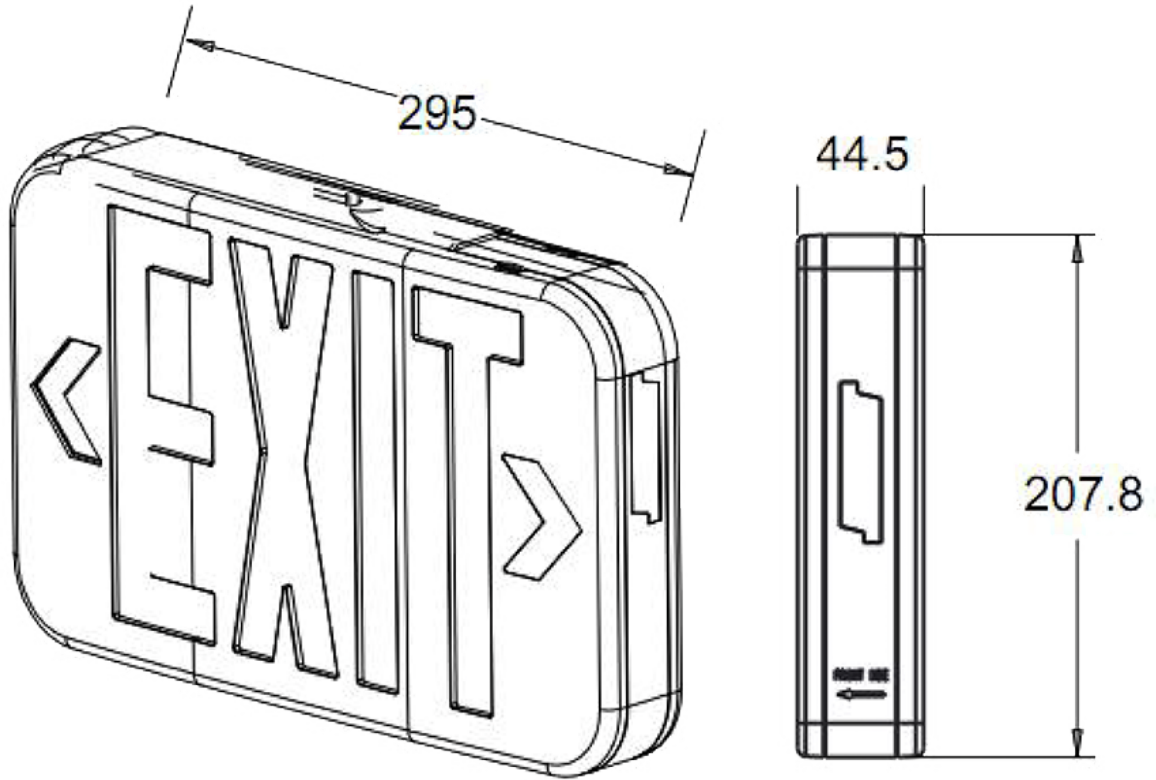

## SHIPPING

Product Dimension (in)	Case Lot	Master Carton Dim. (in)	40' HQ Container Qty	Pallet Qty
11.61 x 7.25 x 1.75	10	22.91 x 10.39 x 12.63	1480 Nos	150 Nos

## MOUNTING INSTRUCTIONS

### Wall mounting

1. Remove mounting plate from fixture.



2. Knockout in back of mounting plate and push wires through the hole.

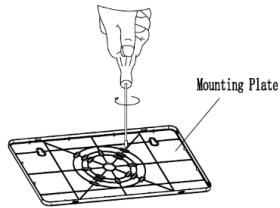

3. Securely attach mounting plate to J- box (not provided).

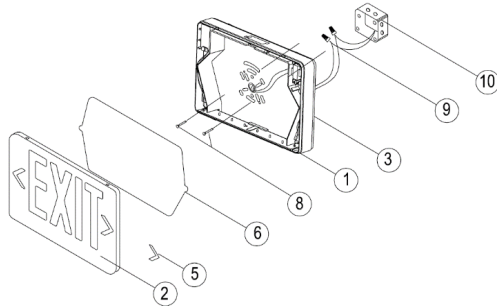

#### 4. ELECTRICAL CONNECTIONS

Make the proper supply wire connections.

If using 120VAC, connect the black and White wires to the building utility.

If using 277VAC, connect the Orange and White wires to the building utility.

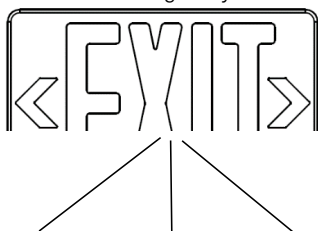

Black  
120VAC  
INPUT

White  
Neutral

Orange  
277VAC  
INPUT

5. Connect the battery to connector on the PCBA.

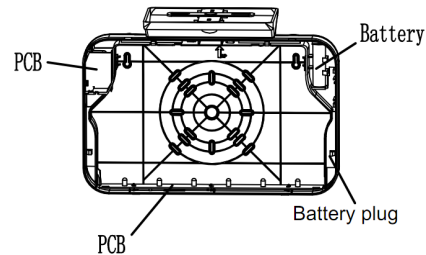

6. Snap fixture onto mounting plate and ensure no wires are pinched. Make sure unit is fully attached.

7. Restore power and press test button. Battery powered LED will come on, AC light will turn off.

### Side or Ceiling Mounting

1. Open top cover and knockout on the top of fixture.
2. Secure the mounting plate to tube with nut.
3. Push the wires through "A" for ceiling mounting or "B" for side mounting.

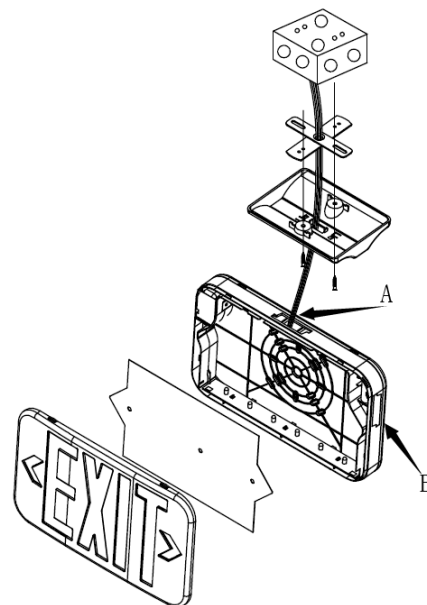

4. Reference step 4-8 in wall mounting above for side or ceiling mounting.